

CMC™ Hose End Fittings QPL-24787-12

Male O-Ring Seal, 90°(CPV)Style For MIL-H-24135/1 Type CL, MIL-F-24787/3 Group I, Type CL

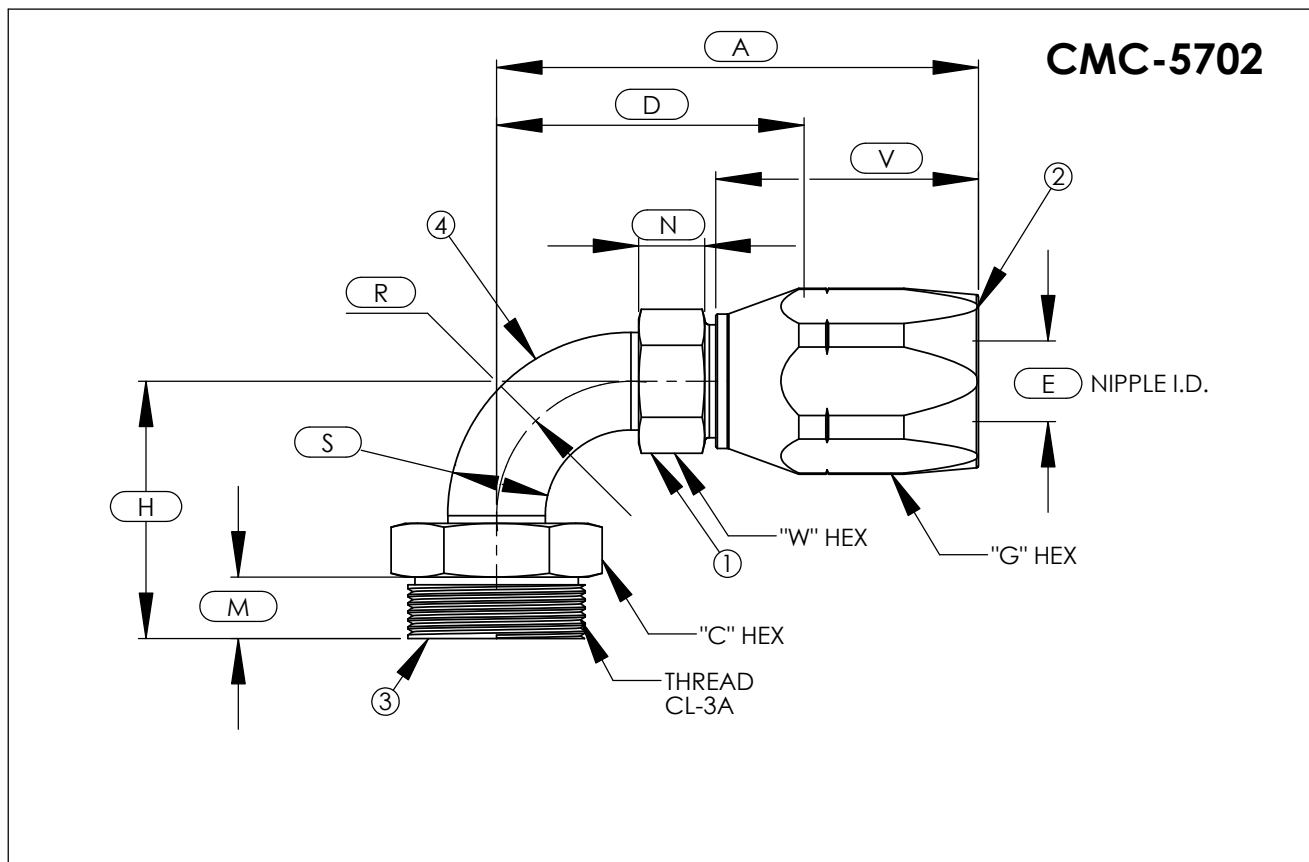

ASSY PART NUMBER	IPS SIZE	THREAD	A	C	D	E	G	H	M	N	R	S	V	W
CMC-XXX-5702-1/4-06	1/4	1 3/16-12	3.11	1.25	1.63	0.31	1.00	1.43	0.62	0.62	0.50	0.38	1.92	0.69
CMC-XXX-5702-3/8-08	3/8	1 3/8-12	3.44	1.44	1.93	0.39	1.12	1.74	0.62	0.62	0.75	0.50	2.01	0.81
CMC-XXX-5702-1/2-12	1/2	1 3/4-12	4.52	1.81	2.65	0.50	1.50	2.31	0.62	0.74	1.25	0.75	2.47	1.06
CMC-XXX-5702-3/4-16	3/4	2-12	5.25	2.12	3.20	0.62	1.81	2.68	0.62	0.74	1.50	1.00	2.95	1.38
CMC-XXX-5702-1-20	1	2 5/16-12	6.10	2.38	3.78	1.05	2.25	3.17	0.75	0.86	1.75	1.25	3.42	1.62
CMC-XXX-5702-1 1/4-24	1 1/4	2 3/4-12	6.32	2.88	4.09	1.28	2.50	3.42	0.75	0.92	2.00	1.50	3.34	1.88
CMC-XXX-5702-1 1/2-32	1 1/2	3 1/16-12	7.38	3.12	4.94	1.75	3.00	4.05	0.88	1.12	2.50	2.00	3.70	2.50
CMC-XXX-5702-2-32	2	3 3/4-12	7.38	3.88	4.94	1.75	3.00	4.05	0.88	1.12	2.50	2.00	3.70	2.50

B.O.M.

COMPONENT PART NUMBERS

- ① ALL SIZES-..... NI-5702-(SIZE)-(MATL CODE)
- ② ALL SIZES-..... SO-5002-(SIZE)-(MATL CODE)
- ③ ALL SIZES-..... CPV-(SIZE)-(MATL CODE)
- ④ MONEL- SIZES 6 THRU 12..... TUBE
- ④ COPPER NICKEL- SIZES 16 THRU 32.TUBE

-EXAMPLE-

CMC-XXX-5702-1/4-06

SEE PAGE 2 FOR ASSY MATERIAL DESIGNATIONS.