

ANSI-B16.5 150 Lb Type V Flange Connection

For SAE 100R5 Hose

CMC-5F01

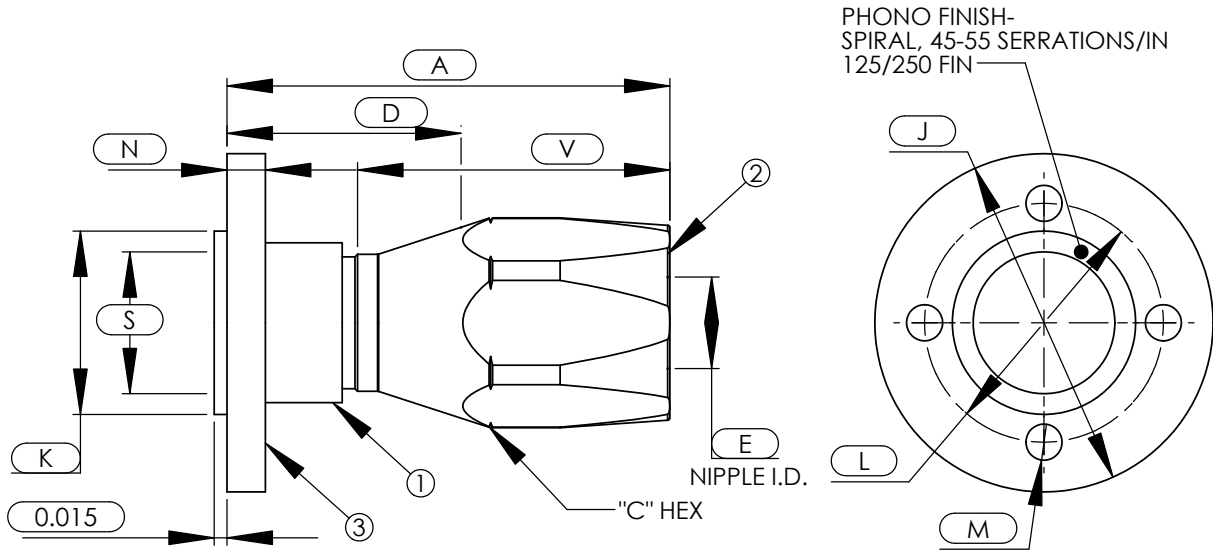

ASSY PART NUMBER	IPS SIZE	NO. OF BOLTS	A	C NOM	D	E	J	K	L	M	N	S	V
CMC-XXX-5F01-1/2-16	1/2	4	2.80	1.44	1.53	0.82	3.50	1.50	2.38	0.62	0.36	0.62	1.66
CMC-XXX-5F01-3/4-20	3/4	4	2.89	1.75	1.53	1.05	3.88	1.84	2.75	0.62	0.42	0.82	1.75
CMC-XXX-5F01-1-24	1	4	2.92	1.94	1.47	1.28	4.25	2.12	3.12	0.62	0.42	1.05	1.84
CMC-XXX-5F01-1 1/4-32	1 1/4	4	3.51	2.50	1.66	1.69	4.62	2.74	3.50	0.62	0.42	1.38	2.25
CMC-XXX-5F01-1 1/2-32	1 1/2	4	3.51	2.50	1.66	1.69	5.00	2.74	3.88	0.62	0.42	1.77	2.25
CMC-XXX-5F01-2-32	2	4	3.51	2.50	1.66	1.69	6.00	2.74	4.75	0.75	0.42	1.77	2.25
CMC-XXX-5F01-2-40	2	4	3.89	3.25	1.98	2.21	6.00	3.28	4.75	0.75	0.42	2.06	2.50
CMC-XXX-5F01-2 1/2-40	2 1/2	4	3.89	3.25	1.98	2.21	7.00	3.28	5.50	0.75	.50	2.06	2.50
CMC-XXX-5101-2 1/2-48	2 1/2	4	3.89	3.88	1.98	2.83	7.00	3.78	5.50	0.75	.50	2.47	2.50

B.O.M.

COMPONENT PART NUMBERS

- ① ALL SIZES.....NI-5F01-(NPS SIZE)-(HOSE SIZE)-(MATL CODE)
- ② ALL SIZES.....SO-5001-(SIZE)-(MATL CODE)
- ③ ALL SIZES.....FL-(NPS SIZE)-(HOSE SIZE)-(TYPE)-(MATL CODE)

-EXAMPLE-
CMC-XXX-5F01-1/2-16

SEE PAGE 2 FOR ASSY MATERIAL DESIGNATIONS.