

# QPL-24787-12 CMC™ Hose End Fittings

Male O-Ring Seal, 90°  
(CPV) Style

For MIL-H-24135/2 Type CL, MIL-F-24787/3 Group II, Type CL

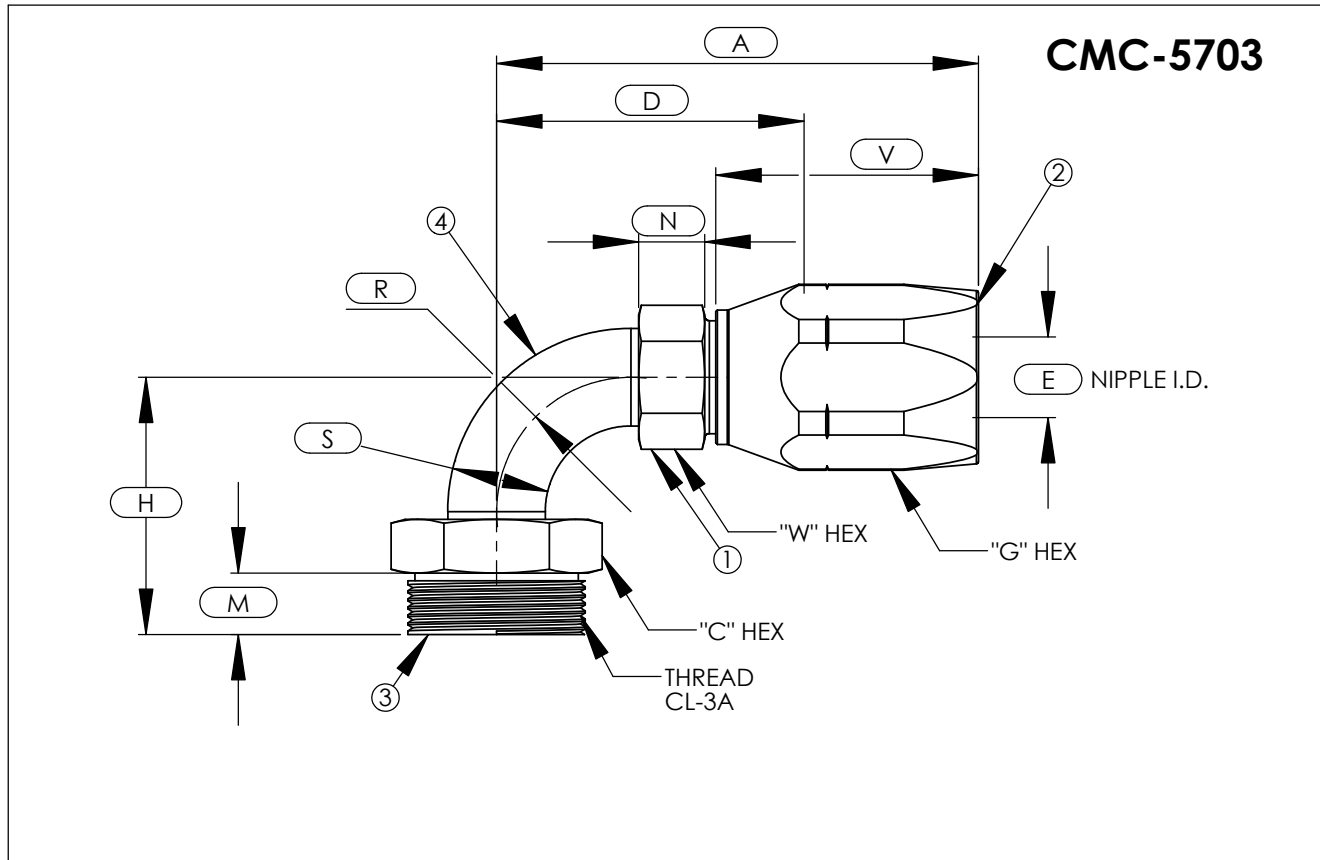

ASSY PART NUMBER	IPS SIZE	THREAD	A	C	D	E	G	H	M	N	R	S	V	W
CMC-XXX-5703-1/4-06	1/4	1 3/16-12	3.11	1.25	1.63	0.31	1.00	1.43	0.62	0.62	0.50	0.38	1.92	0.69
CMC-XXX-5703-3/8-08	3/8	1 3/8-12	3.44	1.44	1.93	0.39	1.12	1.74	0.62	0.62	0.75	0.50	2.01	0.81
CMC-XXX-5703-1/2-12	1/2	1 3/4-12	4.52	1.81	2.65	0.61	1.50	2.31	0.62	0.74	1.25	0.75	2.47	1.06
CMC-XXX-5703-3/4-16	3/4	2-12	5.25	2.12	3.20	0.82	1.75	2.68	0.62	0.74	1.50	1.00	2.95	1.38
CMC-XXX-5703-1-16	1	2 5/16-12	5.25	2.38	3.20	0.82	1.75	2.92	0.75	0.74	1.50	1.00	2.95	1.38

B.O.M.

COMPONENT PART NUMBERS

- ① ALL SIZES-..... NI-5703-(TUBE SIZE)-(HOSE SIZE)-(MATL CODE)
- ② ALL SIZES-.....SO-5003-(SIZE)-(MATL CODE)
- ③ ALL SIZES-.....CPV-(SIZE)-(MATL CODE)
- ④ MONEL- SIZES 6 THRU 12
- ④ COPPER NICKEL- SIZE 16

-EXAMPLE-

CMC-XX-5703-1/4-06

SEE PAGE 2 FOR ASSY MATERIAL DESIGNATIONS.

**custom**

HYDRAULIC & MACHINE INC. (253) 854-4666  
www.customhydraulic.com